

CX-3

AUTO EJECT CAPSULE SPECIALTY DRINK MACHINE

Enjoy delicious coffee, latte's, cappuccinos in a single serve fashion blended with soluble milk and chocolate. The CX-3's unique single step process delivers coffee house quality drinks in under 1 minute each. Simply select your drink, insert a capsule of coffee or tea and brew. There's never a reason to leave the workplace for great tasting coffee again.



DRINK OPTIONS	
	Freshly Brewed Coffee Choose from a full menu of coffees and enjoy the flavor of coffee brewed one cup at a time.
	Espresso A full-flavored, concentrated "shot" of dark, robust coffee.
	Caffè Latte A robust shot of espresso, with a healthy covering of hot steamed milk.
	Cappuccino A robust shot of espresso and equal parts steamed and foamed milk.
	Mochaccino Coffee or espresso blended with whipped hot chocolate and milk.
	Caffè Mocha Coffee or espresso blended with whipped hot chocolate.
	Hot Chocolate Delicious whipped hot chocolate.
	Hot Tea Choose from a full menu of teas including black, green, white and herbal.

The difference is the taste:

The CX-3's new universal platform provides the flexibility to exchange brew mechanisms to brew PODS, or K-Cup™, similar capsules and Solabev capsules. The CX-3 gives you the freedom to choose the right brewing medium for you and your client's business. Individual single portions of coffee and tea capsules provide an aromatic and enjoyable taste experience and choice. Brighten up your work place with the aroma of freshly brewed coffee and enjoy the difference the CX-3 offers.

Unmatched Individuality:

CX-3 includes 98 preset recipes to choose from. Simple, select the recipe you would like to use and assign it to one of the 9 buttons on front. Choose from tea lattes, shot of milk or variable strengths and cup sizes for all recipes. All recipes are pre-programmed and ready to use. Personalize your CX-3 just the way you like, even with a custom branded front, we can do that too.

Brewing Responsibly:

CX-3's innovative use of 2 lb. bulk hoppers for milk and chocolate drastically cut down on waste without sacrificing drink quality. One 2 lb. bag of milk and 2 lb. bag of chocolate is the equivalent of approximately 75 milk and 50 individual chocolate capsules in other brewing systems. The end result is a great coffee experience while helping to protect the environment - one cup at a time.

CX-3

AUTO EJECT CAPSULE SPECIALTY DRINK MACHINE

New Features:

- New Pump Design which reduces noise when the equipment is brewing and provides superior control over the brewing process.
- Improved software for rinsing the whipper bowl to eliminate dripping after dispense of Milk based drinks.
- Universal Brew Mechanism for K-Cup™, similar capsules and Solabev capsules.
- Increased Cup height: removable drip tray and adjustable legs provide the cup clearance for travel mugs.

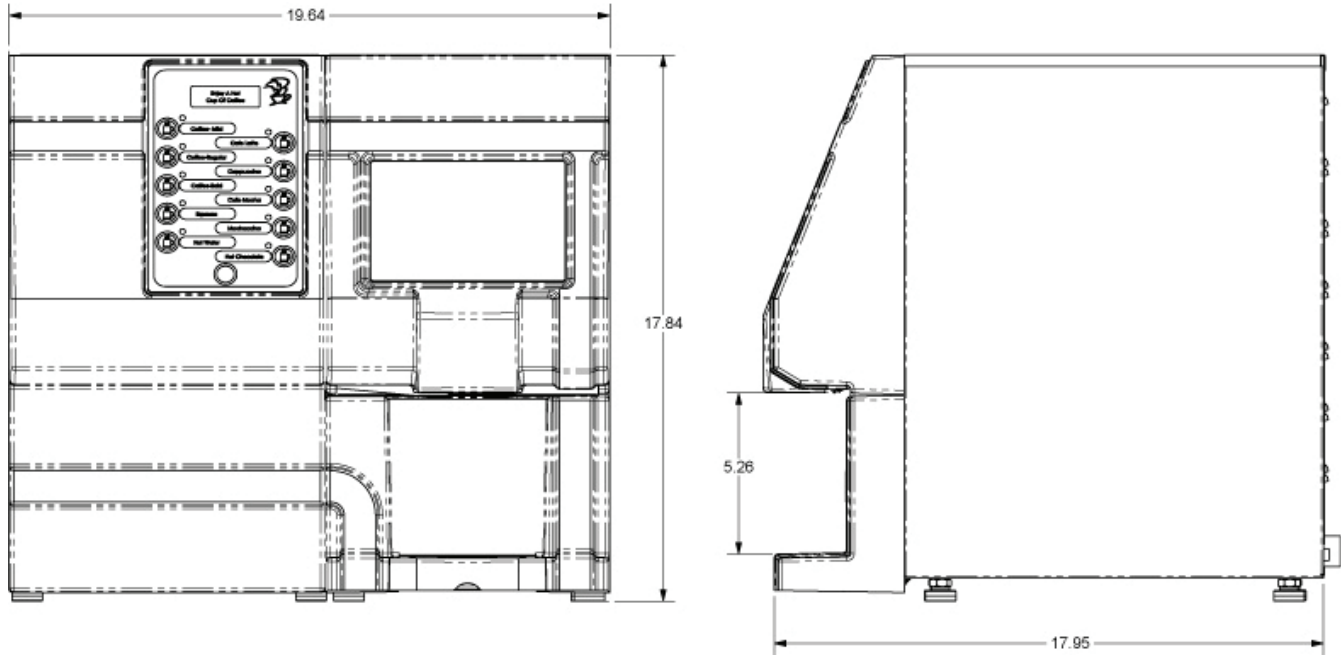

Base Model	Finish	Volts	Amps	Tank Wattage US/CAN	Cubic Feet	Ship Weight	Dimensions W x H x D
CX-3 Cap 782250	Stainless	120V 60HZ	15 US/15 CAN	1750W/1450W	6.5	90 Lbs	19.64" x 17.84" x 17.95"

CLOSE UP OF BREW MECH



Easy Clean Cleaning tablets

Item #	Features / Description
780366	Newco Cleaning tablets 4oz.